

**Manhattanville in West Harlem Implementation Plan Report  
October 15, 2025 Submission**

**Declaration Reference and Key Data**

Obligation Section Number: **5.07(c)(xxiv)**

Obligation Title: **Retail Businesses**

Obligation Page Number: **57**

Obligation Trigger: **CO - First New Building with Small Format Retail Space**

Obligation Start Date: **July 24, 2024 – Issuance of CO for Columbia Business School**

Obligation End Date: **Project Completion**

Obligation Status: **In Compliance**

**Obligation**

*Retail Businesses.* Columbia shall market no less than 12,000 GSF of small format retail space (up to 2,500 GSF per business) on the Project Site for local entrepreneurs and existing local businesses for uses specified in Section 104-16 of the Zoning Resolution. Priority shall be given to any business displaced by the Project that is in compliance and good standing with its lease terms. When feasible, Columbia shall implement the retail strategy that it currently uses in Morningside Heights and will use good faith efforts to reach agreements with on-site retailers, and with businesses compatible with Columbia's and the community's rebuild needs, provided reasonable economic terms can be agreed upon with such businesses.

**Evidence of Compliance**

1. Copy of marketing materials featuring available small format retail space on Project Site
2. Report of community outreach regarding retail space on Project Site

Columbia University's Implementation Plan and all supporting documentation are made available on the Columbia Neighbors Webpage at <https://neighbors.columbia.edu/content/community-commitments>.





COLUMBIA UNIVERSITY -  
MANHATTANVILLE

**RETAIL SPACE**

F O R L E A S E

**COLUMBIA BUSINESS SCHOOL**

# HARLEM, MORNINGSIDE HEIGHTS, HAMILTON HEIGHTS, MANHATTANVILLE

Over the past few years, the trade area surrounding the site has attracted significant commercial, educational, residential and retail investments that have significantly added to the neighborhood's vibrancy and quality of life.



**TRADE AREA**

# MANHATTANVILLE

The Manhattanville campus is situated between City College just to the north, Columbia's Morningside campus just to the south and the Manhattanville Factory District to the east.

The campus plan includes up to 6.8 million square feet of space for teaching, research, university housing and support services. It features new facilities for civic, cultural, recreational and commercial activity. Its improved pedestrian-friendly streets and new publicly accessible open spaces will connect Harlem to the new Hudson River waterfront park.

The Campus currently includes: the 450,000 SF Jerome L. Greene Science Center, the 60,000 SF Lenfest Center for the Arts, the 56,000 SF, 430+ seat Forum, the 210,000 SF Studebaker Hall, and the 100,000 SF Prentiss Hall.

Scheduled for opening in 2022 is the Columbia Business School which consists of two buildings — Henry R. Kravis Hall and David Geffen Hall — for a total of 480,000 additional square feet.

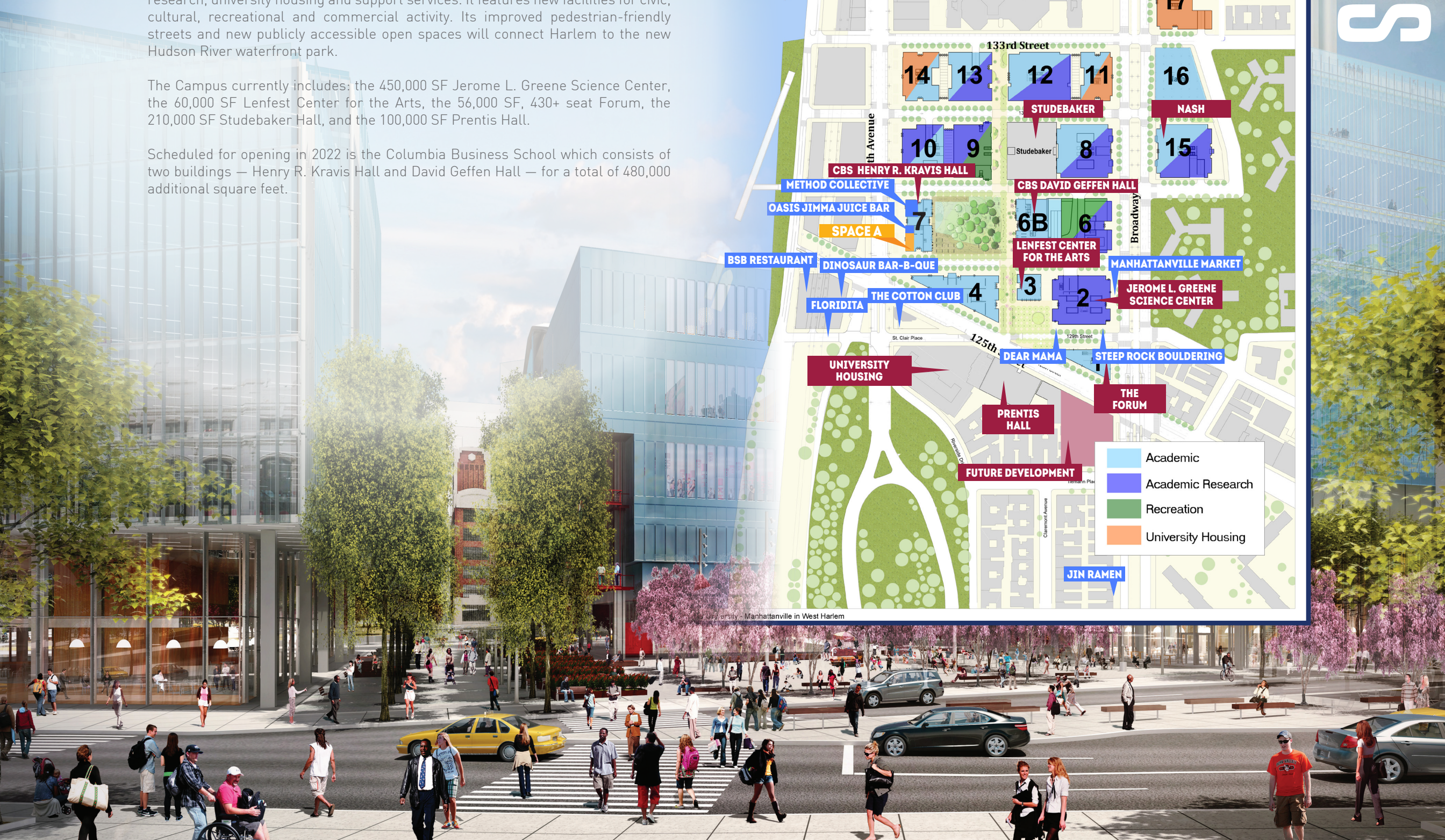
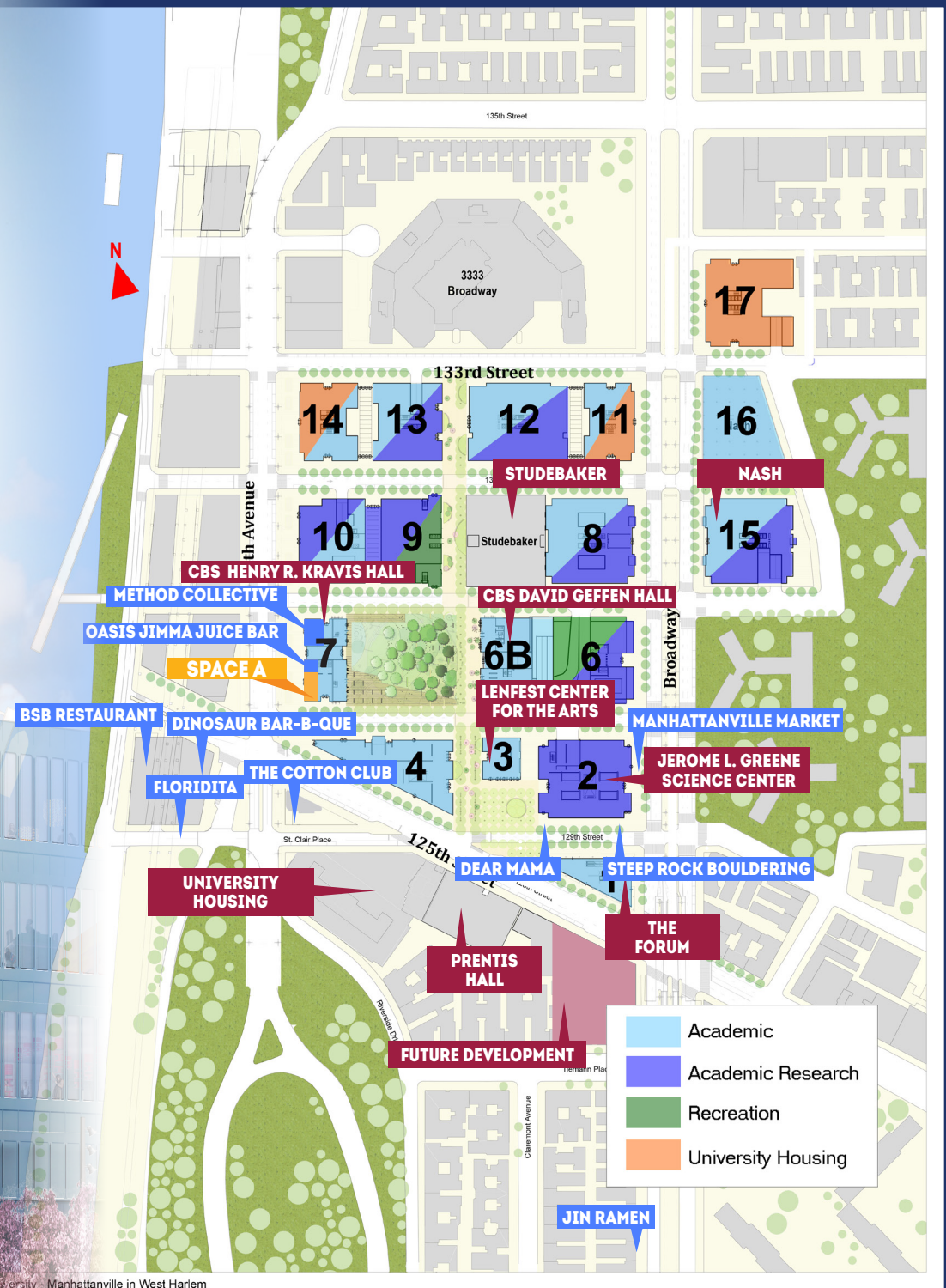



# AVAILABILITY

Two retail spaces are available to lease in Kravis Hall, including the corner of 130th street.

## ADDRESS

Henry R. Kravis Hall — Columbia Business School  
2285 and 2287 12th Avenue  
New York, NY 10027

## PREMISES

**SPACE A1:** 1,035 SF

**SPACE A2:** 1,084 SF

## Ground Floor

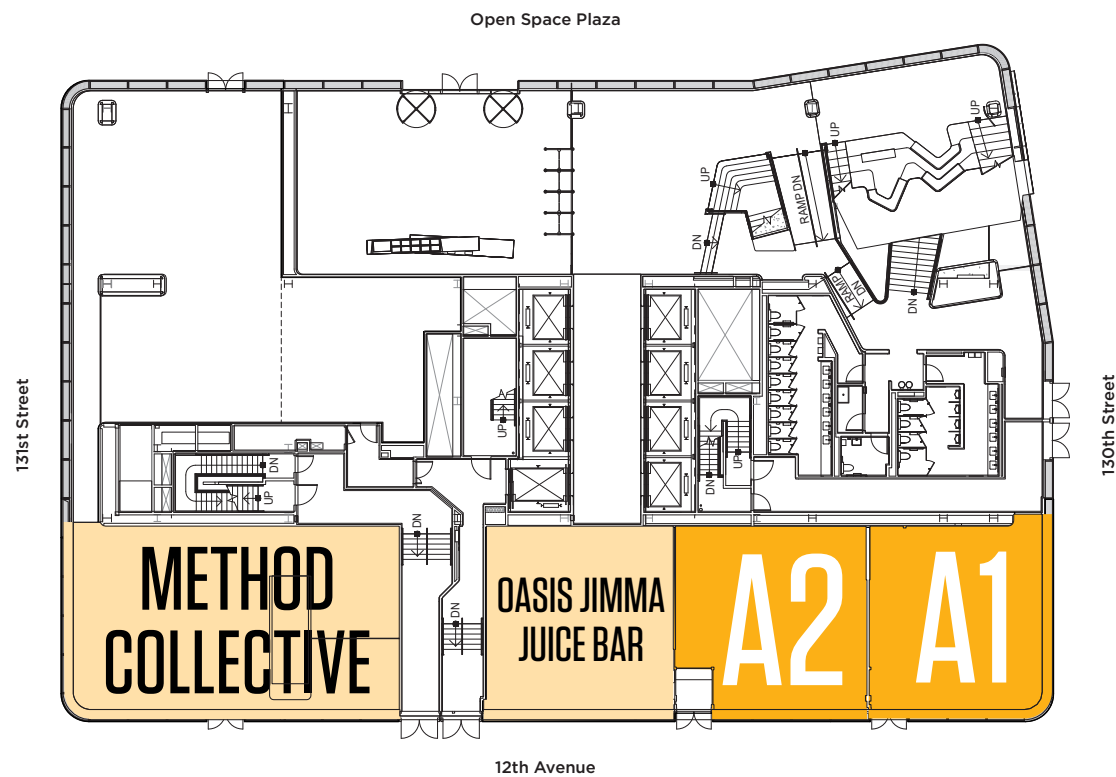

# RETAIL



COLUMBIA UNIVERSITY  
IN THE CITY OF NEW YORK

# COLUMBIA UNIVERSITY – MANHATTANVILLE R E T A I L

For more information, please contact the exclusive agents:

**KENNETH HOCHHAUSER**

212.792.2605

[khochhauser@rtl-re.com](mailto:khochhauser@rtl-re.com)



COLUMBIA UNIVERSITY  
IN THE CITY OF NEW YORK

RTL Partners LLC - Licensed Real Estate Brokers  
655 Third Avenue, 24th Floor • New York, NY 10017 • T. (212) 792.2600 • [www.rtl-re.com](http://www.rtl-re.com)

ALTHOUGH ALL INFORMATION REGARDING PROPERTY FOR SALE, RENTAL OR FINANCING IS FROM SOURCES DEEMED RELIABLE SUCH INFORMATION HAS NOT BEEN VERIFIED, AND NO EXPRESS REPRESENTATION IS MADE NOR IS ANY TO BE IMPLIED AS TO THE ACCURACY THEREOF, AND IT IS SUBMITTED SUBJECT TO ERRORS, OMISSIONS, CHANGE OF PRICE, RENTAL OR OTHER CONDITIONS, PRIOR SALE, LEASE OR FINANCING, OR WITHDRAWAL WITHOUT NOTICE.

## Annual Report: Retail Businesses

State Submission Annual Reporting Period: **October 2024 - September 2025**

Current Leased and Available Small Format Retail Space on Manhattanville Campus				
Building	Address	Premises	Square Footage (SF)*	Current Retail Tenant
Kravis Hall	2285 12th Avenue New York, NY 10027	Space A1	1,035	Available for lease
Kravis Hall	2289 12th Avenue New York, NY 10027	Space A2	1,084	Available for lease
Kravis Hall	2291 12th Avenue New York, NY 10027	Space A3	1,297	<a href="#">Oasis Jimma Juice Bar</a>
Kravis Hall	2293 12th Avenue New York, NY 10027	Space B	1,928	<a href="#">Method Collective</a>
<b>Total SF marketed to date:</b>			<b>5,344</b>	

\* Small format retail space is defined in the Declaration of Covenants and Restrictions as up to 2,500 GSF per business.

## Summary of Outreach Efforts

Columbia University Real Estate has partnered with RTL (formerly Winick Realty Group) since 2015 to procure retail tenants for the Manhattanville campus.

Inquiries about leasing available retail space come via the following methods:

- Manhattanville Retail Availability interest form on the Columbia Neighbors website
- Loopnet/Costar
- RTL website
- Conversations with brokers
- Cold calling/cold emailing
- Visits to existing local businesses to inquire if interested in moving or expanding

### Inquiries/Outreach for available small format retail space:

1. Campus Swing (golf simulators and lessons)
2. Unnamed gym concept
3. H&R Block
4. Cotti Coffee
5. Unnamed pottery studio
6. Unnamed healthy quick-service restaurant
7. Zen Dumpling
8. Mango Mango
9. Unnamed quick-service restaurant
10. International Development Institute
11. Unnamed Food Use
12. Frozen Love
13. Red Kup
14. Testing Shop (health exams)

## Additional Supporting Documentation

- Link to Manhattanville retail availability interest form on Columbia Neighbors website
- Link to broker website with available listings
- Photos of available small format retail spaces within the Project Site
- Announcements of tenants in small format retail space

# Columbia Neighbors

[Home](#) » Manhattanville Retail Availability



## Manhattanville Retail Availability

The Manhattanville campus is situated between City College just to the north, Columbia's Morningside campus just to the south and the Manhattanville Factory District to the east.

The campus plan includes up to 6.8 million square feet of space for teaching, research, university housing and support services. It features new facilities for civic, cultural, recreational and commercial activity. Its improved pedestrian-friendly streets and new publicly accessible open spaces will connect Harlem to the new Hudson River waterfront park.

The Campus includes the 450,000 SF Jerome L. Greene Science Center, the 60,000 SF Lenfest Center for the Arts, the 56,000 SF, 430+ seat Forum, the 210,000 SF Studebaker Hall, and the 100,000 SF Prentis Hall.

Recently opened, the Columbia Business School which consists of two buildings, Henry R. Kravis Hall and David Geffen Hall, offers a total of 480,000 additional square feet.

## Location

Henry R. Kravis Hall — Columbia Business School  
2285 - 2293 12th Avenue  
650 West 131st Street  
New York, NY 10027

## Retail Spaces

There are currently two retail spaces available to lease in Kravis Hall.

- Space A1: 1035 SF
- Space A2: 1084 SF



Additional information can be found via [this downloadable PDF.](#)

## Submit an Inquiry

All inquiries should be made by completing the following form.

### Contact Information

Name \*



Name of Retail Business \*

Email \*

Phone \*

Address \*

Address 2

City/Town \*

State/Province \*

ZIP/Postal Code \*

## Business Information

Please Describe Your Business in a Few Sentences \*

Where is your business headquartered? \*

Website



I'm not a robot

reCAPTCHA  
[Privacy](#) - [Terms](#)

Submit

Between 130th and 131st Street

West Harlem



Request Information

Download Brochure

Share Listing

**2285-2293 12th Avenue, New York, NY 10027**

## Property Details

Neighborhood:	West Harlem
Total Space:	2,245 SF
Property Type:	Lease
Asking Rent:	Upon Request

## Comments

## Neighbors

## Contact Exclusive Agents:



### **Kenneth Hochhauser, EVP**

 212-792-2605

 [khochhauser@rtl-re.com](mailto:khochhauser@rtl-re.com)

 [@kenneth-hochhauser](#)



**Latest Exclusives**

21 Maiden Lane  
2913 Broadway  
1395 St Nicholas Avenue  
27-01 Jackson Avenue  
519 West 27th Street  
26-32 Jackson Avenue



RTL Partners, LLC  
Licensed Real Estate Brokers  
655 Third Avenue, 24<sup>th</sup> Floor  
New York, NY 10017

**Follow Us**



[Subscribe to Our Mailing List](#)

212-792-2600

[info@rtl-re.com](mailto:info@rtl-re.com)



2285 12 Ave



2289 12 Ave

## RETAIL OPENINGS

# Women-Owned Fitness Co-op Opens in Manhattanville

January 12, 2024



Method Collective, a women-owned, mat-based movement space, has opened at 2293 12th Avenue (corner of 131st Street) in Manhattanville.

Founded in 2023 by Leah Roth, Patricia Ruiz, and Dani Zuccheri, Method Collective offers a diverse range of fitness classes, including yoga, pilates, and other fitness modalities. Method Collective's new location establishes a physical home for the fitness co-op where classes can be held year-round following their launch in the adjacent West Harlem Piers Park.

Method Collective is offering promotional rates and trial classes in conjunction with its opening. Patrons can join Method Collective on Friday, February 2 to take a complimentary class at 5:15 p.m., followed by its grand opening celebration at 6:30 p.m., and take advantage of a 10 percent discount on memberships and class packages. Method Collective is also hosting open house events exclusive to Columbia University affiliates the week of January 22, offering select free classes and added discounts for memberships and class packages.

Columbia University owns and manages retail space across the Morningside and Manhattanville campuses, and its long-standing retail approach favors businesses that bring a variety of amenities and experiences to the University and its local communities. Method Collective is the first retail tenant to open in one of the four small-format retail spaces along 12th Avenue, designed for entrepreneurial tenants to develop their businesses, on the ground floor of Columbia Business School's Henry R. Kravis Hall.

To learn more or schedule a class, visit Method Collective's [website](#) and follow them on [Instagram](#).

## News

January 12, 2024

[Women-Owned Fitness Co-op Opens in Manhattanville](#)

January 11, 2024

[Columbia University Brings Health Food and Juice Bar to its Manhattanville Campus](#)

January 03, 2024

[Minority-Owned, Independent Boxing Gym Opens in Morningside Heights](#)

December 22, 2023

[inFO: CUFO e-Newsletter, December 2023](#)

December 22, 2023

[Columbia Business School Wins the 2023 Prix Versailles World Title Special Award in Campuses Category](#)

# Method Collective

Yoga • Pilates • Fitness





Scan for class  
schedule

# Yoga Pilates Fitness

Method  
Collective

2293 12th Ave. @ 131st Street

Columbia Business School @ Henry R. Kravis Hall

Method Collective

2293 12 Ave



Method Collective



Please Scan for Hours of  
Operation & Class Schedules

Method  
Collective

Yoga • Pilates • Fitness

LOBEX

ctive

2293 12Ave

Method Collective



Please Scan for Hours of  
Operation & Class Schedules

# Method Collective

Yoga • Pilates • Fitness

## Columbia University Brings Health Food and Juice Bar to its Manhattanville Campus

January 11, 2024



Oasis Jimma Juice Bar, a minority-owned juice bar and café, has signed a lease with Columbia University to open a new location at Columbia Business School's Henry R. Kravis Hall.

Founded in 2012, Oasis Jimma Juice Bar stands as a harmonious convergence of flavor and health with an unwavering commitment to offering healthy and affordable fruit and vegetable-based options. Their new location in Henry R. Kravis Hall will be just over 1,000 square feet and serve healthy juices and smoothies with breakfast, sandwiches, salads, and more. The new space is anticipated to open in fall of 2024 and will be Oasis Jimma Juice Bar's fourth location in Upper Manhattan.



# FACILITIES AND OPERATIONS

prompting him to turn to holistic nutrition and his teacher's teachings to treat his ailments. Abajebel saw success with his homemade juices and began selling them to local institutions. Later that year, Abajebel took a leap of faith and opened Oasis Jimma Juice Bar in Harlem.

"The decision to establish our fourth location at Columbia University's Henry R. Kravis Hall, Manhattanville Campus, feels like a natural progression. Our ties with Columbia University have deepened over time; we've served students, collaborated with the staff, provided catering services for diverse events, and made deliveries to various schools. We are incredibly excited to embark on this collaboration, furthering our mission while strengthening our relationship with the Columbia community," said Abajebel.



Oasis Jimma Juice Bar will be the second retail tenant in Henry R. Kravis Hall's small-format retail spaces along 12th Avenue, joining the fitness and yoga studio, Method Collective. The four spaces, each sized under 2,000 square feet, are designed to attract entrepreneurial tenants like Oasis Jimma Juice Bar by offering a unique opportunity to house their businesses.

Columbia owns and manages retail space across the Morningside and Manhattanville campuses, and its long-standing retail approach favors businesses that bring a variety of amenities and experiences to Columbia and its local communities. Oasis Jimma Juice Bar will join several other local businesses that have recently opened or signed leases in Columbia buildings in Morningside Heights and Manhattanville, including [HIIT The Deck](#), [Method Collective](#), [FIELDTRIP](#), [Ban Ban Shop](#), [Miznon](#), and [Sapp's Restaurant](#).

To learn more about Oasis Jimma Juice Bar, follow them on [Facebook](#) and [Instagram](#).

Tags: [Real Estate](#) [Manhattanville](#)

## News

January 12, 2024

[Women-Owned Fitness Co-op Opens in Manhattanville](#)

January 11, 2024

[Columbia University Brings Health Food and Juice Bar to its Manhattanville Campus](#)

January 03, 2024

[Minority-Owned, Independent Boxing Gym Opens in Morningside Heights](#)

December 22, 2023

[inFO: CUFO e-Newsletter, December 2023](#)

December 22, 2023

[Columbia Business School Wins the 2023 Prix Versailles World Title Special Award in Campuses Category](#)